

4500 Vertical Sump Pumps

Deming Column Sump Pumps are unmatched in quality, standardized design and construction to meet the demanding requirements of continuous pumping operation. Compare the many superior features of these pumps that contribute to long dependable service life.

Metallurgy in all irons, bronze fitted, all bronze, steel, stainless steel and other machinable alloys. Provision for handling liquids to 400°F. Single pump or duplex unit with two single pumps mounted on common duplex sump cover.

ADVANTAGES:

Always Primed

- Submerged in liquid being pumped.

Compact

- Minimum floor space required.

Leak-Proof

- No gland or mechanical seal in liquid contact.

Low Installation Cost

- Minimum foundation and piping required.

Versatile

- Adjustable, semi-open impeller to maintain performance.
- Above or below plate discharge.
- Vented or vapor-tight construction.
- Optional guide bearing assemblies.

TYPICAL APPLICATIONS:

- Sump Drainage
- Flood Control
- Air Wash Systems
- Power Plants
- Industrial Processes
- Condensation Control
- Pollution Control
- Dewatering Service
- Process Plants
- Utility Service

Capacities to 3000 GPM
Heads to 150 Feet
Depths to 20'
Sizes 1½"-10" discharge
Speeds to 3500 RPM



*Quality + Versatile Design =
Long Dependable Service*

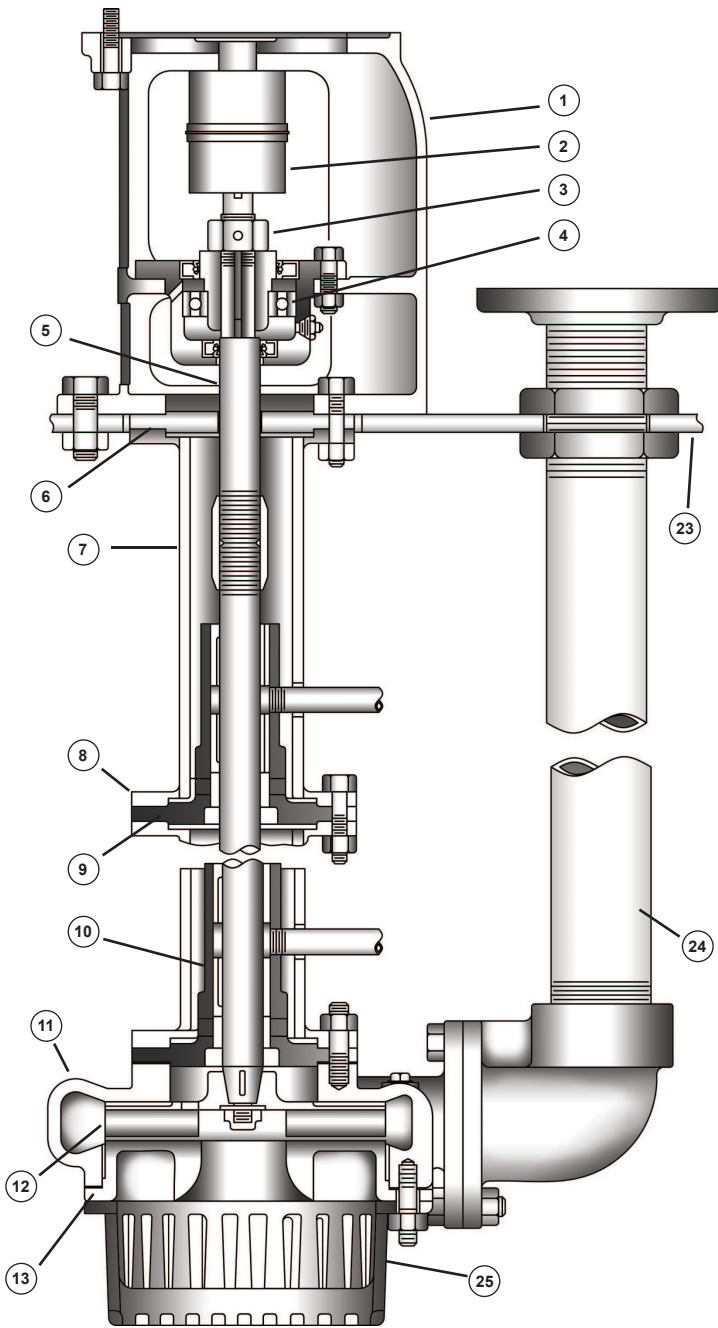

Design Features:

1. Frame - for standard NEMA C and P Flange normal thrust motors. Other drives optional.
2. Flexible coupling - Standard jaw-type is used, with grid style or a FAST brand available as an option.
3. Impeller Adjusting Nut - adjustable without dismantling pump.
4. Thrust Bearing - high thrust capacity, water-proof housing, purge type grease lubrication.
5. Shaft - precision machined of a high grade carbon steel and optional alloys.
6. Column Closure - optional designs to suit applications.
7. Column Pipe - full weight steel with welded flanges.
8. Machined registered fit at all assembly points from motor to suction head assures concentric alignment and quiet operation.
9. Intermediate bearing assembly - optional designs for difficult applications - located at 3' to 5' intervals.
10. Bottom Bearing Assembly - optional designs to suit application.
11. Volute Type Casing - flanged and threaded discharge - double volute type with 3" and larger discharge.
12. Impeller - high efficiency heavy process design, keyed to shaft and secured by locknut and washer.
13. Suction Head - 4501, 4511 and 4521, permits easy replacement if required. On the 4560 series, the suction head is cast integral with casing.
14. Bearing Housing - heavy duty, designed for maximum loads. (Not shown)
15. Bearing Bushing - variety of materials available for specific requirements. (Not shown)
16. Choker Ring - resists entrance of solids or abrasives into bottom bearing. (Not shown)
17. Packing Box - used with vapor tight construction. Available with 3 or 5 packing rings. (Not shown)
18. Split gland - easy packing maintenance for sealing at plate. (Not shown)
19. Lantern Ring - permits lubrication or flushing liquid to packing box. (Not shown)
20. Packing - graphite. (Not shown)
21. External lubrication fitting - optional for pressurized fluid or grease (in and out connections). (Not shown)
22. Spring - maintains pressure on packing. (Not shown)
23. Support plate - Standard as part of the pump unit. Vapor tight construction optional.
24. Discharge pipe-above or below plate outlet.
25. Suction strainer.

CRANE[®]

A Crane Co. Company

PUMPS & SYSTEMS

Crane Pumps & Systems
420 Third Street
Piqua, Ohio 45356
(937) 778-8947
Fax (937) 773-7157
www.cranepumps.com

Crane Pumps & Systems Canada
83 West Drive
Brampton, Ont. Canada L6T 2J6
(905) 457-6223
Fax (905) 457-2650



© 2012 Crane Pumps & Systems, Inc.
A Crane Co. Company
Printed in U.S.A.
D4500BRO - Rev. B (6/12)



brands you trust.

BARNES[®]

burks[®]

DEMING[®]

WEINMAN[®]



PROSSER[®]