



HYMAX GRIP[®]

COUPLING RESTRAINT (16")

HYMAX[®]
Repair the past. Connect the future.

INSTALLATION INSTRUCTIONS

DO NOT DISASSEMBLE THE COUPLING. DO NOT LUBRICATE THE BOLTS.

GENERAL INSTRUCTIONS:

THE HYMAX GRIP IS A STAB-ON TYPE RESTRAINT THAT IS APPROVED FOR USE WITH METAL AND PLASTIC PIPES.

WARNING: DO NOT ATTEMPT TO USE THE HYMAX GRIP ON AC OR FRP PIPE!

PRECAUTIONS FOR HDPE PIPE: THE USE OF FULL CIRCLE STIFFENERS IS REQUIRED WHEN USING THE HYMAX GRIP ON HDPE PIPE.

FOR OTHER MATERIALS, PLEASE CONTACT KRAUSZ USA OR YOUR KRAUSZ DEALER.

STEP 1

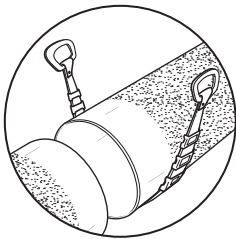

Prepare both pipe ends of the pipe by de-scaling if required. Clean the pipe as required with water. Make sure that the pipe is clean from debris and defects that interfere with GRIP's proper seal.

NOTE: Except steel, PVC, and PE pipes, all rough-surfaced pipes must be lubricated with a water-based gasket lubricant in order to achieve a proper seal.

STEP 2

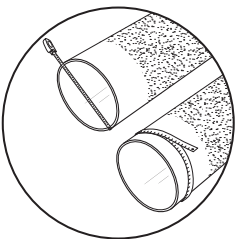

Measure the pipe's outer diameter and make sure the coupling's size fits properly.

NOTE: Each coupling's size range is shown on the product's label. Make sure that the pipe is not out of round! The pipe should be free of scratches, dents, flats or other defects which may interfere with the coupling's proper seal. The coupling may not fit well or function properly on a pipe which is damaged or is out of round.

STEP 3

Unpack the coupling. Carefully remove the GRIP from its packaging. Inspect the coupling and end rings for shipping damage and assure all parts are present. Inspect the end rings. If they are not centered on the coupling - DO NOT USE! Contact your distributor for return and replacement.

NOTE: HYMAX GRIP is a stab-on type coupling. Do not loosen or remove the end ring bolts.

NOTE: Bolts are pre-lubricated with a MAG coating. This embedded zinc lubrication will prevent cold weld. Do not lubricate the bolts and nuts. Greasing or lubricating bolts or nuts voids the manufacturer's warranty.

STEP 4

Mark each pipe end to a minimum required stab depth as indicated on the product label. These marks indicate the required stab depth of the pipe on the coupling.

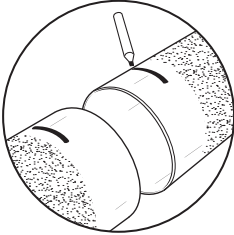

STEP 5

The HYMAX GRIP fits a wide range of pipe sizes. The range is shown on the product's label.

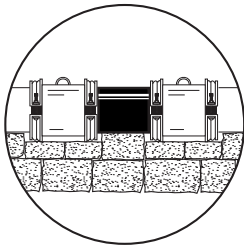

Make sure that the pipes are properly supported. The HYMAX GRIP is not designed to carry the weight of the pipes.

STEP 6

Slide the two HYMAX GRIP couplings on both sides of the replacement pipe. Lower the replacement pipe and the two grips positioned on it into the ditch.

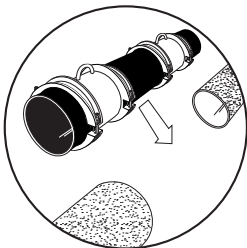

STEP 7

Slide the two HYMAX GRIPs from the replacement pipe in the direction of the two old pipes until they reach the pipe marks shown in step 4.

NOTE: Make sure that the pipes are not touching each other inside the body of the HYMAX GRIP. There must be space between the pipes in order for "Continuous Dynamic Deflection" (CDD) to take place.

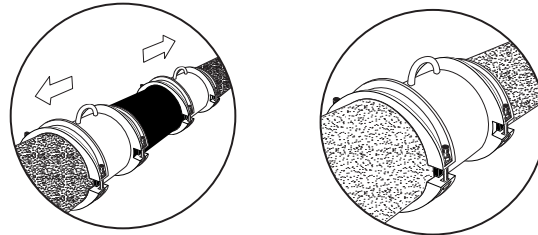

STEP 8

Tighten the end rings using a torque wrench, to the correct torque shown on the product's label.

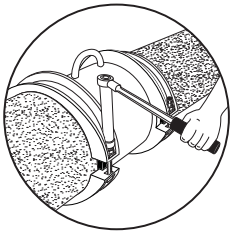

IMPORTANT: On each side, tighten the two bolts alternately, one after the other. By tightening bolts the couplings are steadily stabbed on the pipe.

NOTE: Use a torque wrench to tighten the bolts - this is required. A torque wrench will assure a proper torque has been applied to the coupling.

STEP 9

Recharge the line and check for leaks. If any leakage is evident, reduce the pressure in the line and increase bolt's torque by up to 50%. Verify again no leaks are evident along the seal.

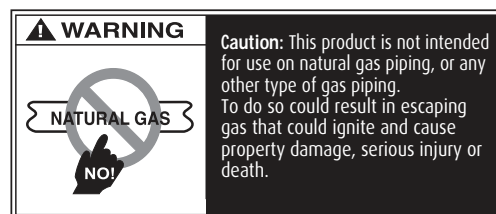

KRAUSZ USA. 331 SW 57TH AVENUE, OCALA, FLORIDA 34474 • INFO@KRAUSZUSA.COM

FOR ORDERING INFORMATION OR TO SPEAK WITH A KRAUSZ REPRESENTATIVE PLEASE CONTACT US AT:
855-457-2879 OR 855-4KRAUSZ. • FAX: 352-304-5787 • WWW. KRAUSZUSA.COM

HYMAX GRIP® is a registered trademark of Krausz Industries Ltd. Copyright © 2018 Krausz Industries Ltd. All rights reserved. This product is protected under a registered patent. See Krausz' website for details.