

# Typical Specification

Models L7, L8  
Bulletin 1100

# WEINMAN®

www.cranepumps.com

## Split Case Pumps - Vertically Mounted

### Double Suction with Mechanical Seals

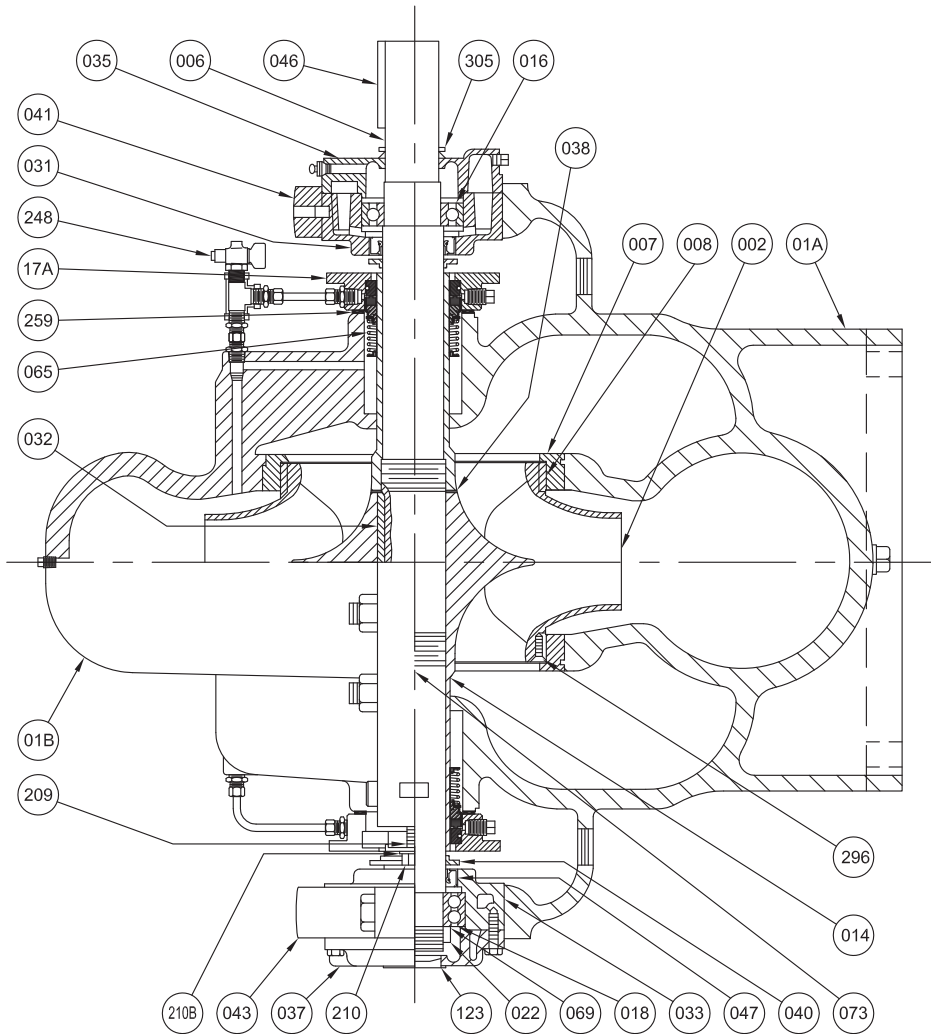

Item No.	Name of Part
1A	Lower Half Casing
1B	Upper Half casing
* 2	Impeller
6	Shaft
* 7	Casing Ring
‡ * 8	Impeller Ring (Not Shown)
14	Shaft Sleeve
* 16	Inboard Bearing
* 18	Outboard Bearing
22	Bearing Lock Nut
31	Inboard Bearing Housing
* 32	Impeller Key
33	Outboard Bearing Housing
35	Inboard Bearing Cover
37	Outboard Bearing Cover
38	Shaft Sleeve Gasket
40	Deflector (Liquid)
41	Inboard Bearing Cap
43	Outboard Bearing Cap
46	Coupling Key
47	Lip Seal
* 65	Mechanical Seal
68	Seal Collar
69	Lock Washer
* 73	Casing Gasket - Suction Side (Not Shown)
* 73A	Casing Gasket - Discharge Side (Not Shown)
123	Bearing End Cover
127	Seal Piping
192	Retaining Ring (Bearing)
209	Swing Bolt
210	Nuts
210B	Washer
248	Pet Cock
251	Seal Cap
259	Seal Gland Gasket
296	Set Screws
305	Pipe Plug

\* For domestic service we recommend these parts be carried in stock as spares

‡ Double wearing rings furnished as standard equipment on 8" and larger pumps all other as special equipment only

\* Recommended Spare Parts

SECTION 1100  
PAGE 6  
DATE 10/18

**CRANE**  
A Crane Co. Company

PUMPS & SYSTEMS

USA: (937) 778-8947 • Canada: (905) 457-6223 • International: (937) 615-3598