

Frame Mounted End Suction, Flanged Connection

PUMP NO.	PUMP:	MOTOR:	VOLTS:
FOR:	TDH:	HP:	HZ:
CERT. BY:	GPM:	RPM:	FRAME:
DATE:	FIGURE NO:	PHASE:	ENCLOSURE:

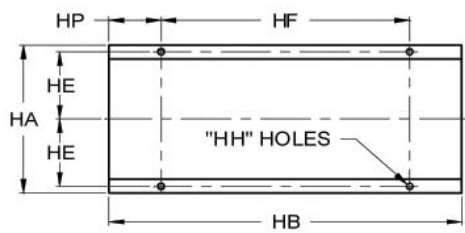

CONNECTIONS FOR 125# STANDARD FLANGES								
PUMP	DISCH. (INCH)	INLET (INCH)	HL	X	Y	Z	CP	DD
1G-2A	1	1.25	10.44	5.00	4.33	4.10	19.94	5.00
1.5G-2A	1.5	2	9.63	5.70	3.58	4.30	19.13	5.63
1.5G1-2A	1.5	2	9.63	5.70	3.58	4.30	19.13	5.63
1.5GT-2A	1.5	3	11.38	5.70	5.33	4.30	20.88	5.63
1.5K-2A	1.5	2	10.00	6.50	3.65	6.70	19.56	7.25
1.5K1-2A	1.5	2	10.00	6.50	3.65	6.70	19.56	7.25
1.5KH-2A	1.5	2	10.38	7.50	4.87	6.70	20.00	8.00
2G-2A	2	3	10.13	5.50	4.13	4.50	19.63	5.81
2K-2A	2	3	10.00	6.70	3.83	6.00	19.56	7.50
2.5G-2A	2.5	3	10.19	6.25	4.03	4.50	19.69	6.06
2.5K-2A	2.5	3	10.44	7.00	4.06	6.25	19.88	7.69
3G-2A	3	4	11.00	6.00	4.63	4.80	20.50	6.63
3K-2A	3	4	10.88	7.50	4.48	6.50	20.38	8.13
3K1-2A	3	4	10.88	7.50	4.48	6.50	20.38	8.13
4G-2A	4	5	11.25	6.75	4.77	5.50	20.75	7.38
4G1-2A	4	5	11.25	6.75	4.77	5.50	20.75	7.38
4GL-2A	4	5	11.25	6.75	4.77	5.50	20.75	7.38

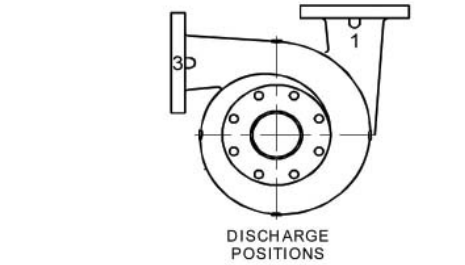
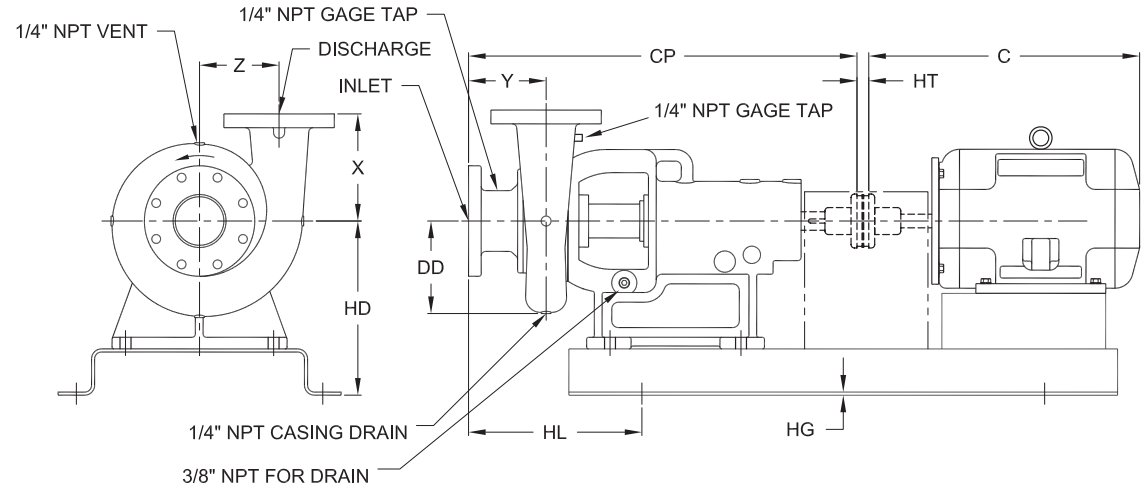

NOTES: 1) All dimensions $\pm .13$ 2) Dimension C will vary based on motor brand

DIMENSIONS IN INCHES

MOTOR FRAME	BASE NO.	C		HA	HB	HD	HE	HF	HG	HH	HP	HT
		ODP	TEFC									
48	010031	9.63	10.75	15.50	30.00	10.50	6.75	22.00	.25	.75	4.00	3.75
56	010029	11.25	13.38	15.50	30.00	10.50	6.75	22.00	.25	.75	4.00	3.75
143T	012015	12.81	11.50	15.50	30.00	10.50	6.75	22.00	.25	.75	4.00	3.75
145T	012015	12.81	11.50	15.50	30.00	10.50	6.75	22.00	.25	.75	4.00	3.75
182T	011584	13.63	16.13	15.50	30.00	10.50	6.75	22.00	.25	.75	4.00	3.75
184T	011584	13.63	16.13	15.50	30.00	10.50	6.75	22.00	.25	.75	4.00	3.75
213T	011658	15.50	18.63	15.50	35.00	10.50	6.75	27.00	.31	.75	4.00	3.75
215T	011658	17.00	20.13	15.50	35.00	10.50	6.75	27.00	.31	.75	4.00	3.75
254T	011952	20.31	23.75	19.00	36.00	10.50	8.50	28.00	.31	.75	4.00	3.75
256T	011952	22.06	25.50	19.00	36.00	10.50	8.50	28.00	.31	.75	4.00	3.75
284TS	010035	22.00	24.75	19.00	36.00	10.50	8.50	28.00	.31	.75	4.00	3.75
286TS	010035	23.50	26.25	19.00	36.00	10.50	8.50	28.00	.31	.75	4.00	3.75

Types "G, GL, GT, K & KH"

End Suction Frame Pumps No. 2A Bearing Frame with Spacer Coupling - Metric (Millimeters)



www.cranepumps.com

Frame Mounted End Suction, Flanged Connection

PUMP NO.	PUMP:	MOTOR:	VOLTS:
FOR:	TDH:	HP:	HPZ:
CERT. BY:	GPM:	RPM:	FRAME:
DATE:	FIGURE NO:	PHASE:	
		ENCLOSURE:	

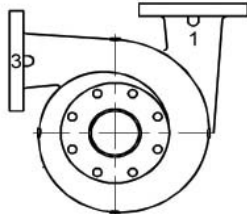

DISCHARGE POSITIONS

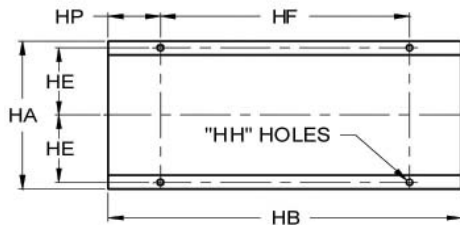

CONNECTIONS FOR 125# STANDARD FLANGES

PUMP	DISCH. (INCH)	INLET (INCH)	HL	X	Y	Z	CP	DD
1G-2A	1	1.25	265	127	110	104	506	127
1.5G-2A	1.5	2	244	144	91	109	486	143
1.5G1-2A	1.5	2	244	144	91	109	486	143
1.5GT-2A	1.5	3	289	144	135	109	530	143
1.5K-2A	1.5	2	254	165	92	170	497	184
1.5K1-2A	1.5	2	254	165	92	170	497	184
1.5KH-2A	1.5	2	263	190	123	170	508	203
2G-2A	2	3	257	139	105	114	499	148
2K-2A	2	3	254	170	97	152	497	191
2.5G-2A	2.5	3	258	158	102	114	500	154
2.5K-2A	2.5	3	265	177	103	158	505	195
3G-2A	3	4	279	152	117	122	521	168
3K-2A	3	4	276	190	113	165	518	206
3K1-2A	3	4	276	190	113	165	518	206
4G-2A	4	5	285	171	121	139	527	187
4G1-2A	4	5	285	171	121	139	527	187
4GL-2A	4	5	285	171	121	139	527	187

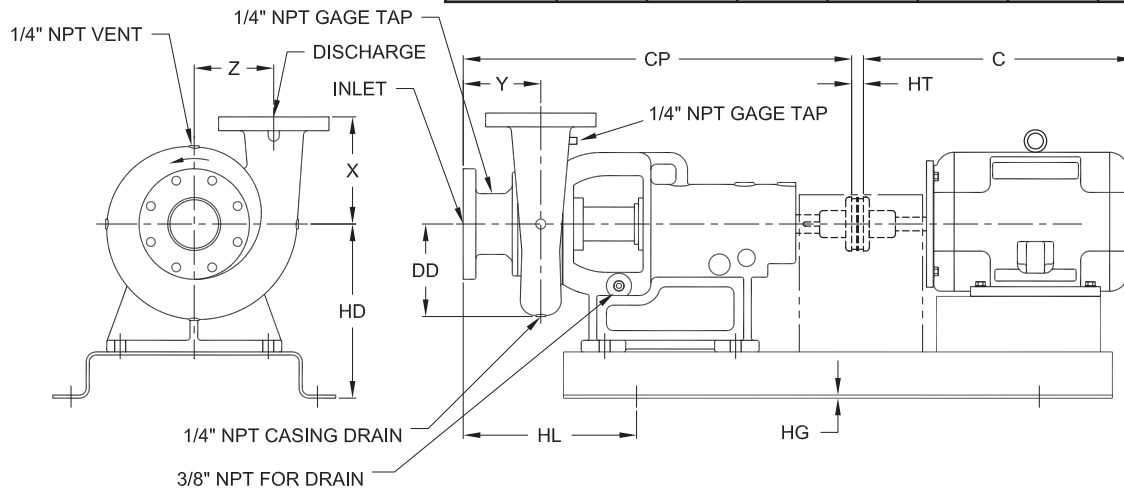

NOTES: 1) All dimensions $\pm .13$ 2) Dimension C will vary based on motor brand

DIMENSIONS IN MILLIMETERS

MOTOR FRAME	BASE NO.	C		HA	HB	HD	HE	HF	HG	HH	HP	HT
		ODP	TEFC									
48	010031	245	273	394	762	267	171	559	6	19	102	95
56	010029	286	340	394	762	267	171	559	6	19	102	95
143T	012015	325	292	394	762	267	171	559	6	19	102	95
145T	012015	325	292	394	762	267	171	559	6	19	102	95
182T	011584	346	410	394	762	267	171	559	6	19	102	95
184T	011584	346	410	394	762	267	171	559	6	19	102	95
213T	011658	394	473	394	889	267	171	686	8	19	102	95
215T	011658	432	511	394	889	267	171	686	8	19	102	95
254T	011952	516	603	483	914	267	216	711	8	19	102	95
256T	011952	560	648	483	914	267	216	711	8	19	102	95
284TS	010035	559	629	483	914	267	216	711	8	19	102	95
286TS	010035	597	667	483	914	267	216	711	8	19	102	95

SECTION 500
PAGE 20
DATE 4/10



A Crane Co. Company

PUMPS & SYSTEMS

USA: (937) 778-8947 • Canada: (905) 457-6223 • International: (937) 615-3598